

4 Ellen Place, MARGARET RIVER

Property Details

FOR SALE

4 Ellen Place, MARGARET RIVER



EXCLUSIVE RIVERSIDE SPLENDOUR

5  3  3 

*** THIS PROPERTY IS CURRENTLY AVAILABLE FOR PRIVATE INSPECTIONS ***

Hidden away in this very private exclusive Margaret River enclave, is this magnificent and impressive executive residence. Perched perfectly on the sunny, north facing slope of a generous 2.5 acre

- 5 Bedrooms
- 3 Bathrooms
- 3 Toilets
- 3 Garages
- 3 Living Areas
- Inside Spa

(1.02Hec) parkland cleared lot, and set amongst gorgeous gardens, the property is quite at home as a family residence, or equally at home as a high end getaway, with its retreat like ambience. With an unparalleled locality, this home is idyllically positioned between town and the coast in a peaceful, private locale on the banks of the Margaret River. The outlook is stunning to the riverside native forest, that sets the delightful backdrop and view as you enter the property down a very picturesque undulating tree lined driveway.

The contemporary and unique compound design boasts four separate buildings wrapped around a central multi-level internal courtyard with multiple nooks to while away the time in total privacy. The open plan design continues into the main building and out onto the huge elevated entertainment, deck area which overlooks the river reserve. An Idyllic spot to share sunset drinks on the deck with the forest trees lit up at night.

This magnificent residence features a dazzling gourmet kitchen with Granite Bench Tops and quality appliances, with light streaming in from the adjoining dining area, with its Clerestory Windows in the soaring roof line / bulkhead. Queensland Beech timber flooring features in the entry and living area, overlooking the large sunken lounge area with inviting wood fire and under floor heating. The cosy snug area off the main living area is a perfect getaway for some down time. Where you can nestle up in front of the two metre wide built in feature fireplace.

Outside in the internal courtyard another fireplace features in one of the break away zones. Ideal to keep warm whilst taking in the stars on those clear Margaret River nights.

The luxurious master bedroom sits within the main structure and is very well proportioned with walk through wardrobe and spacious spa bathroom and own private terrace and lawn area. This pod features another very good sized bedroom and laundry area, and WC.

Another separate two bedroom pod with own bathroom area overlooks the central courtyard from a slightly more elevated position, with bedrooms very good in size, and both with their own north west facing deck areas. The upper level pod consists of a very large games room area with built in bar. Easily adapted for a multitude of uses with barn doors to the driveway, ideal for storing any four or two wheeled big boy, or girls, toys. And to top it off, perfect for the inevitable guests that you have when you

- Open Fire Place
- Grey Water System
- Remote Garage
- Deck
- Floor boards
- Built In Robes
- Dishwasher

it on, perfect for the inevitable guests that you have when you own a property in Margaret River, there is a separate guest loft bedroom above the large double garage with its own bathroom. <https://my.matterport.com/show/?m=A3qDUNcgGW3> and https://drive.google.com/drive/folders/1L26Woj5y0UMXn8osPSvZ-c0Fzp8l2TTR?usp=sharing_eil&ts=5e758bbd

Expressions Of Interest

Photo Gallery









Looking to rent or buy? This is the process we're following to ensure your safety.

Explore our photos, 3D floorplans, virtual tours.

Arrive at the scheduled Open Home inspection and maintain social distancing requirements.

Confirm that you haven't returned from overseas in the past 14 days and you're not filling with coronavirus in location.

Remaining discussions/ negotiations conducted via phone, video conference and our online systems.

INSPECTION RULES

No personal contact—no shaking hands.

10
MAXIMUM

Maximum of 10 people including the agent in the home at once.

Social distancing - 1.5m between agent and clients at all times.

No touching—please ask our staff to open anything you wish to inspect.

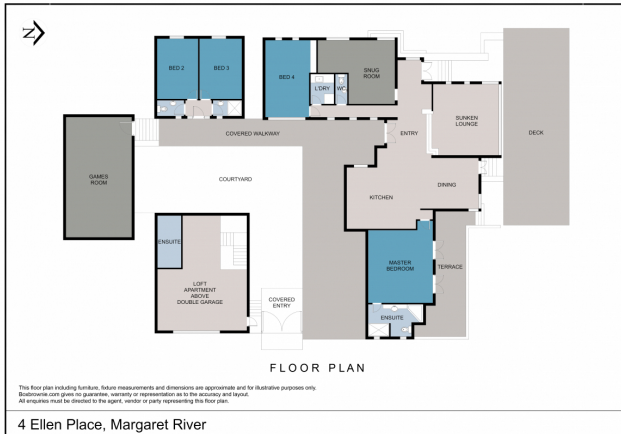

**Want to see more of
4 Ellen Place, MARGARET RIVER?**

[email Craig Bamford](mailto:craig.bamford@firstnational.com.au)

or call him on 0417 922 223
to arrange an inspection.

Property Location

4 Ellen Place, MARGARET RIVER

10200 sqm

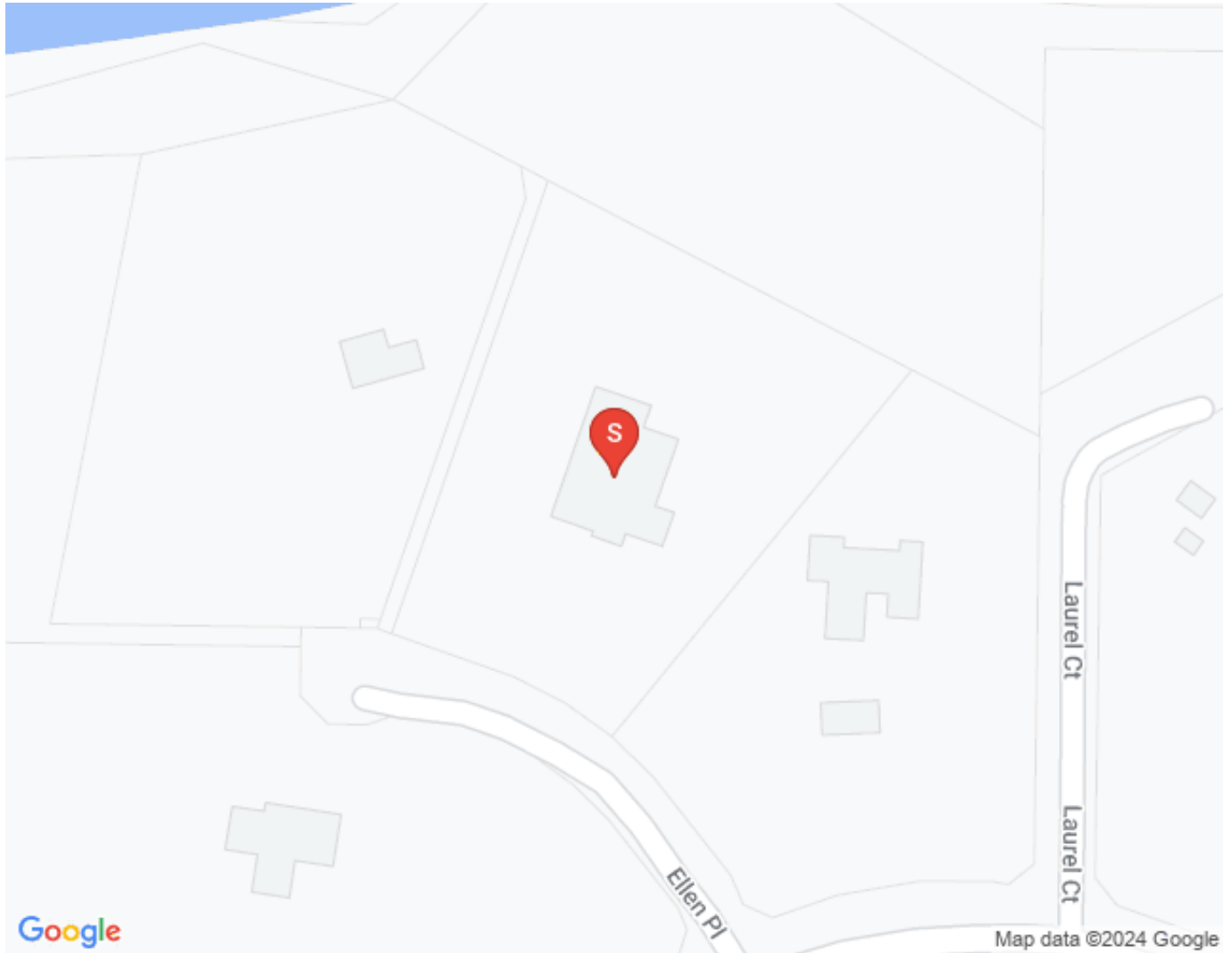

Your Agent



Craig Bamford

m: 0417 922 223

e: craig@margaretriverrealestate.com.au

Craig has been successfully selling real estate of all types in Margaret River for well over two decades and is recognised as one of the top property consultants in the region. His dedication to his profession sees him consistently being named as one of the Top 10 consultants in the entire First National network.

Craig is the exclusive selling agent for 4 Ellen Place, so if you have any queries please don't hesitate to [email him](mailto:craig@margaretriverrealestate.com.au) or call him on 0417 922 223.

Recent feedback from some of Craig's clients...

We had such a great experience working with Craig Bamford at Margaret River Real Estate First National to buy our house. Craig was so professional, personable & genuine & very generous with his time & in sharing his knowledge, which helped to make the whole experience really smooth & enjoyable. We would highly recommend Craig & the team at Margaret River Real Estate First National.

- Samantha Togni

A successful transaction does not occur by chance. Success, in most real estate transactions, is entirely attributed to the professionalism of a real estate agent. Craig Bamford, you are a professional real estate agent. You never influenced me, you listened attentively and acted on it. I was impressed by your honesty and efficiency. Communicating with you was easy and effortless. I will not hesitate to recommend you to any future client. I'm a contented customer.

- N Marsella

I have found the First National Real Estate Office and in particular Craig Bamford to be extremely

professional and friendly to deal with. His service and advice have been fast, accurate and efficient and with more than a little local knowledge sprinkled in to make the process of locating and purchasing real estate in this beautiful but competitive market location, Margaret River, a real pleasure. I believe Craig and the First National team are good at what they do because they really enjoy what they do and it shows.

- E & P McLagan



[Read our Google Reviews](#)

Our Agency



Margaret River Real Estate First National

Margaret River Real Estate First National is the first choice for the most advanced real estate services. We sell, rent and manage land and residential, lifestyle, rural, industrial, and commercial property in the heart of the south west Capes of Western Australia. We are dedicated to delivering an exceptional experience from our Margaret River office, so every member of our team strives to make a difference.

From the very initial contact, right through the entire buying or selling process, our property consultants and specialist team of administrative and marketing professionals will be by your side every step of the way. If you've been waiting for the ideal time to buy, sell or lease property...it's now. Let us show you why!

...and whether you choose Margaret River Real Estate First National to **buy, sell, rent or manage** your property, you can be sure we'll offer you carefully tailored solutions, the highest level of professionalism and the most experienced, highly regarded real estate agents and property managers in Margaret River.

Our aim is to get you better results, faster.

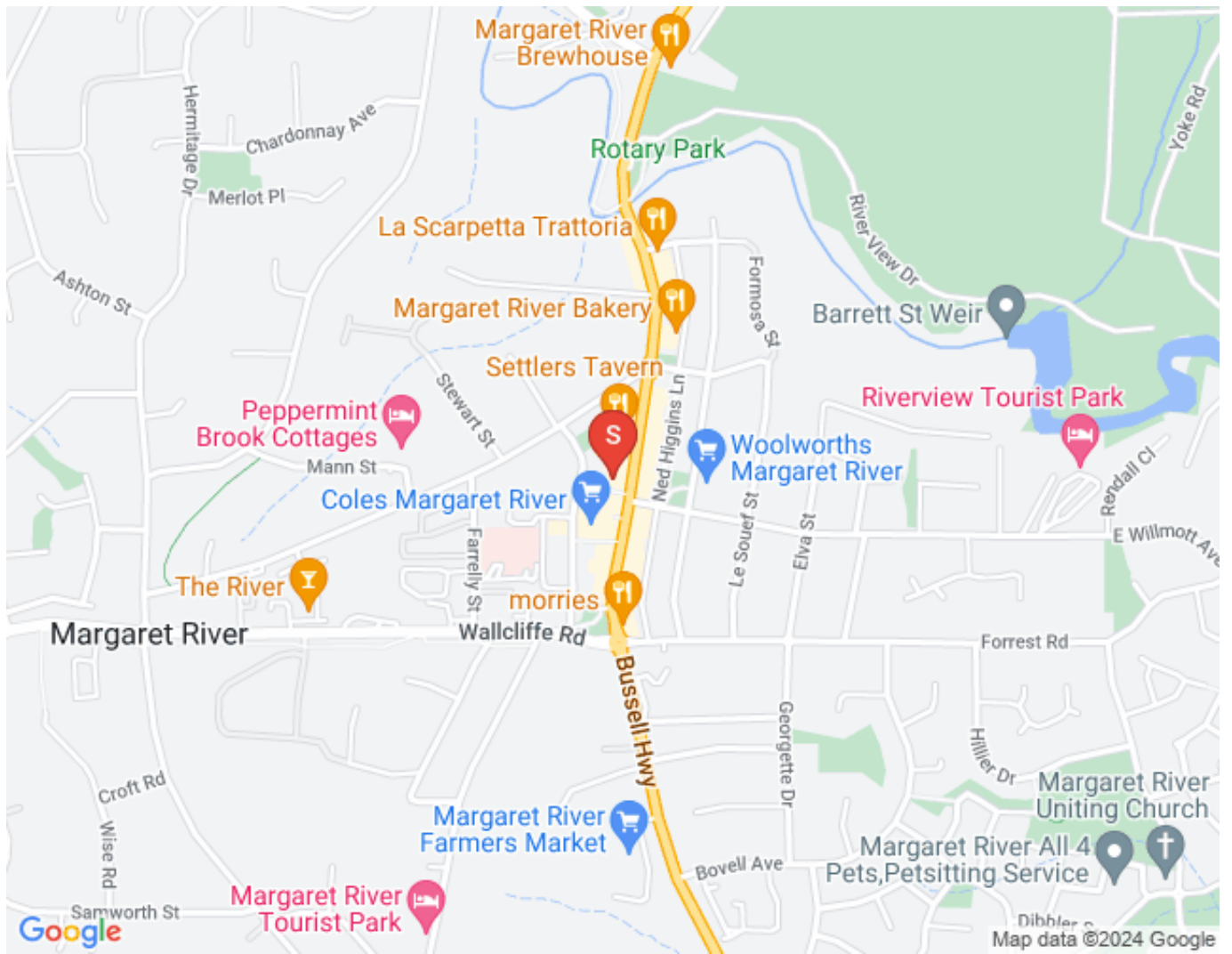

Around the Area

The Margaret River Region



Margaret River is one of Western Australia's best tourist draw cards as it is world renowned for its winemaking, spectacular surf breaks and coastal scenery. Towering forests and picturesque vineyards provide scenic delight above ground whilst magnificent limestone caves form unique beauty underground. Located just 300 kilometres south of Perth, Margaret River is a holiday destination that is accessible to all and each year, some 1,500,000 overnight visitors embrace the diversity of this surfing, scenic wine growing region. The Augusta Margaret River region is enriched with wide range of cultures, characters and activities and supports a local population of approximately 15,000, making it one of the fastest growing shires in Australia.

Margaret River Real Estate sells in nine areas of the region and each one of these areas is unique in its characteristics and appeal. To find out more about these regions, click on these links to see the lifestyle opportunities and property styles they offer, as well as other properties for sale in their vicinity:

[MARGARET RIVER - The Heart of the South West Capes](#)

[PREVELLY - Where the River Meets the Ocean](#)

[GNARABUP - Overlooking the Indian Ocean](#)

[COWARAMUP - Full of Country Charm](#)

[WITCHCLIFFE - Gateway to the South](#)

[ROSA GLEN & ROSA BROOK & FOREST GROVE - Inland Rural Living](#)

[GRACETOWN - On the Coast at Cowaramup Bay](#)

[KARRIDALE - On the Edge of the Forest](#)

[HAMELIN BAY - Overlooking Pristine Coastline](#)

Schools in the Area



There are eight primary schools within the Margaret River High School catchment area, four of them being in the actual townsite of Margaret River and the others being in Cowaramup, Karridale, Augusta and Forest Grove.

Click on [this link](#) to see the exact locations of all of these schools.

Catchment areas for Margaret River Primary School and Rapids Landing Primary school fall within specific street boundaries in the Margaret River area, so it may be useful to click on their boundary locations as this may affect your choice of property to buy.

[Catchment Area for Margaret River Primary School](#)

[Catchment Area for Rapids Landing Primary School](#)

Helpful Information

Buying a home is about the biggest financial commitment you'll ever have to make, so just as well it's one of the things in life that DOES come with guidebooks!

As much as buying a home is an exciting turning point in your lifestyle, you certainly don't want to make any mistakes. Our Home Buyer's Guide is exactly what you need to get prepared and secure your perfect home, as soon as you find it. This Guide outlines how to find the home of your dreams, how to finance it, negotiate and secure the purchase and how to prepare to move in.

Please use the following link for a readable and printable PDF file:

[Home Buyer's Guide](#)



Perhaps you are considering purchasing a property for investment purposes and want to maximise your capital return by securing rental income throughout the life of your investment. Our Property Management Guide outlines all the issues you need to consider when making this decision.

Please use the following link for a readable and printable PDF file:

[Investing in Property](#)



If you are seriously considering an investment property, leave all the rental management to our award winning Property Management team!

Please use the following link for a readable and printable PDF file to see how we can manage your property with ease:

[Manage your Property with Margaret River Real Estate](#)

**“We’re the KEY to
Managing Your Home.”**



**first
national**
REAL ESTATE | Margaret River



Our Website

Click [here](#) to view 4 Ellen Place and similar properties on our website.

